



powered by **Haier**

Commercial Stainless Steel

Hospital and Mortuary Equipment

Everyday



Hospital and mortuary equipment

High quality products, locally manufactured by Kwikot

Since its launch in the early 2000's, the Kwikot Stainless Steel brand has consistently partnered with key manufacturers and suppliers as part of its vision to produce high-quality, lasting products you can trust. In addition to hospital and mortuary equipment, the Kwikot Stainless Steel commercial range extends further to catering equipment, sanitary ware, and security products.

Kwikot Stainless Steel is dedicated to providing quality products and solutions to market with the back up of exceptional service and support.



INDEX

Content

Page

Stainless Steel Sluice Sinks and Combination Bedpan Wash-up Sinks	4
Bedpan and Bottle Racks	6
Slop Hopper	7
Drip Sinks	8
Surgeon Scrub-up Units	10
Mini Surgeon Scrub-up Units	12
Plaster of Paris Preparation Sink	13
Baby Baths	14
Post Mortem Tables	15
Shelving	16
Z Series Wall Band Shelving - Solid or Perforated	
Fast Rack Modular Shelving - Solid or Louvered	
Kwikboil Units - Instant boiling water dispensers	20

Hospital equipment

Stainless Steel Sluice Sinks and Combination Bedpan Wash-up Sinks

Features

- Grade 304 (18/10) stainless steel
- Durable and hygienic
- Alternative fixing methods
- Sluice bowl with integral flushing rim
- Unit supplied complete with fittings on board
- Recessed draining board to help prevent spillage



SEL LH/RH

Dimensions

Top view

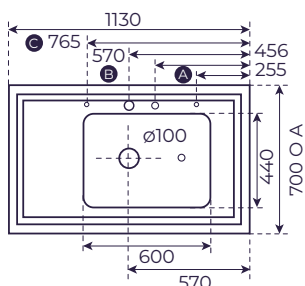

Side view

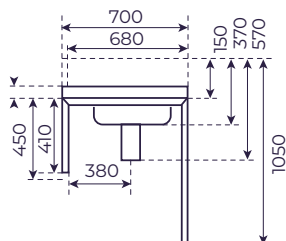

- A - 15mm Cold water
- B - 35mm Cold water
- C - 15mm Cold water



Alternative flushing

Kwikot SHL-CIS

High Level Cistern, manufactured from grade 304 (18/10) stainless steel fitted with PVC Beta valve and pull chain connected to 41mm round stainless steel flush pipe and CP on brass adaptor. (Optional accessory)

Description	Product Code	Configuration	Sink Dimensions L x W (mm)
SEL Sluice Sink with flush master	SEL-1130-LH/RH	Single Bowl	1130 x 700
SEL Sluice Sink with cistern and flush pipe	SEL-1130-LHC/RHC	Single Bowl	1130 x 700

Specifications

Kwikot SEL Sluice Sink, size 1130 x 700mm, manufactured from 1,6mm thick grade 304 (18/10) stainless steel with a 150mm high integral splashback to the back of the unit.

Unit fitted with one sluice bowl having an integral flushing rim. Waste outlet 100mm round. Unit supplied complete with Cobra FM1.000 flush valve, 15mm round bedpan spray nozzle, 15mm round bottle spray nozzle (both nozzles activated by 2x Cobra metering underwall stoptaps 1/2 inch chrome plated).

Unit to be fitted to wall and floor with 40mm square galleys brackets at rear and 40mm square stainless steel front legs with adjustable foot pieces.

Pictures may vary from the actual product. Specifications may differ and will be subject to actual product (E and OE).

Hospital equipment

Stainless Steel Sluice Sinks and Combination Bedpan Wash-up Sinks

Features

- Grade 304 (18/10) stainless steel
- Durable and hygienic
- Alternative fixing methods
- Sluice bowl with integral flushing rim
- Unit supplied complete with fittings on board
- Recessed draining board to help prevent spillage



Dimensions

Plan view

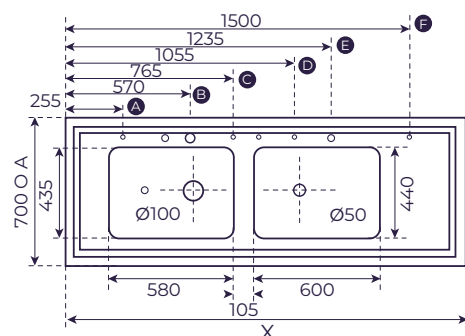

End view

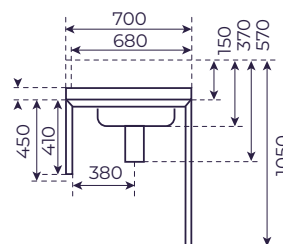

- A - 15 mm Cold water
- B - 35mm Cold water
- C - 15mm Cold water
- D - 15mm Cold water
- E - 15mm Cold water
- F - 15mm Hot/Cold water

Description	Product Code	Configuration	Sink Dimensions L x W (mm)
SEC Combination Bedpan and Wash-up Sink with flush master	SEC-1830-LH/RH	Double Bowl	1830 x 700
	SEC-2135-LH/RH	Double Bowl	2135 x 700
	SEC-2440-LH/RH	Double Bowl	2440 x 700
SEC Combination Bedpan and Wash-up Sink with cistern and flush pipe	SEC-1830-LHC/RHC	Double Bowl	1830 x 700
	SEC-2135-LHC/RHC	Double Bowl	2135 x 700
	SEC-2440-LHC/RHC	Double Bowl	2440 x 700

Specifications

Kwikot SEC Combination Bedpan Wash-up Sinks, manufactured from 1,6mm thick grade 304 (18/10) stainless steel with a 150mm high integral splash back to the back of the unit.

Unit fitted with two bowls with the sluice bowl having an integral flushing rim. Waste outlet 100mm round on sluice bowl and 40mm round on rinse bowl.

Unit supplied complete with Cobra FM1.000 flush valve, 35mm round water supply, CP171/041 pillar type sinkmixer, 15mm round bedpan spray nozzle, 15mm round bottle spray nozzle (both nozzles activated by 2x Cobra Metering underwall stoptaps 1/2 inch chrome plated) and Grohe bauflow Shower mixer (G-29046000) deck mounted and connected to Grohe lead-through pull out (G-27151000) and retractable Grohe tempesta-f trigger spray hose (G-275112001).

Unit to be fitted to wall and floor with 40mm square gallows brackets at rear and 40mm square stainless steel front legs with adjustable foot pieces.

Hospital equipment

Bedpan and Bottle Racks



BBR2

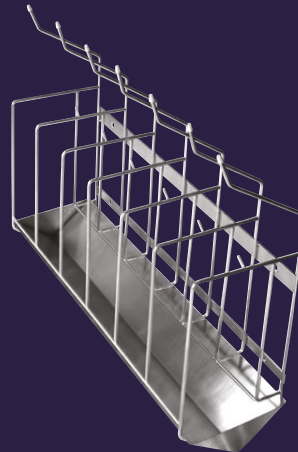

BBR6

Dimensions

Plan view

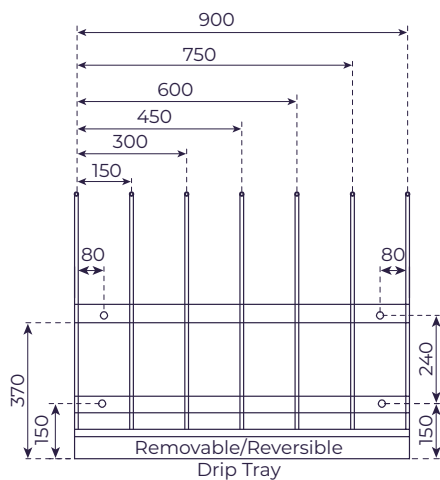

End view

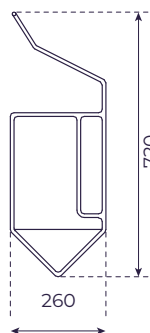

Features

- Grade 304 (18/10) stainless steel 1,2mm gauge
- Durable and hygienic
- Available in 3 standard sizes
- Rubber grommets to ends of bottle rack to prevent scratching of bottles
- Removable stainless steel drip tray

Product Code	Dimensions (mm)	No of Pans	No of Bottles
BBR2	305 x 560 x 260	2	3
BBR4	610 x 560 x 260	4	5
BBR6	915 x 560 x 260	6	7

* Custom sizes available on request

Specifications

Kwikot Bedpan and Bottle Racks are manufactured in grade 304 (18/10) stainless steel complete with removable stainless steel drip tray and rubber grommets fitted to ends of bottle rack to prevent scratching of bottles.

Pictures may vary from the actual product. Specifications may differ and will be subject to actual product (E and OE).

Hospital equipment

Slop Hopper



SLOP-STD (KSH)

Dimensions

Plan view

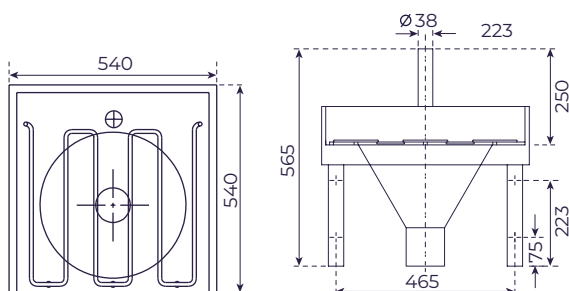

End view

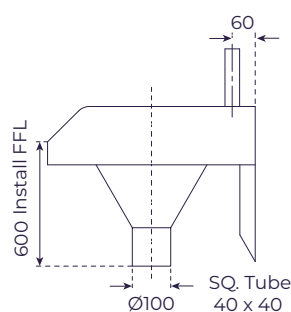

Slop hopper with grid and stainless steel with brackets and 100mm splashback

Features

- Grade 304 (18/10) stainless steel
- Durable and hygienic
- Stainless steel hinged bucket grid
- Stainless steel wall mounting brackets
- Outlet to suit standard 110mm PVC or cast iron "P" trap



Alternative flushing

Kwikot SHL-CIS

High Level Cistern, manufactured from grade 304 (18/10) stainless steel fitted with PVC Beta valve and pull chain connected to 41mm round stainless steel flush pipe and CP on brass adaptor. (Optional accessory)

Product Code	Dimensions L x W (mm)
SLOP-STD	540 x 540

Specifications

Kwikot SLOP-STD (KSH) Slop Hopper manufactured in 1,2mm thick grade 304 (18/10) stainless steel. Unit complete with stainless steel grid, size 540 x 540mm, with a 100mm integral splashback to back with an integral flushing rim fitted with a 38mm round x 250mm long vertical flush pipe inlet. A hinged bucket grid fitted over the funnel manufactured from 10mm grade 304 (18/10) stainless steel round bar. Unit fitted on 40 x 40mm stainless steel wall fixing brackets having 4x number 8mm round holes for fixing to wall.

Hospital equipment

Drip Sinks



SDRIP-STD (KDSG)

Dimensions

Plan view

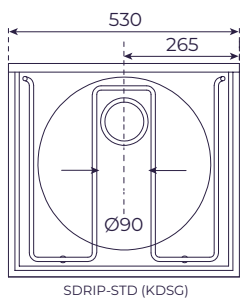

End view

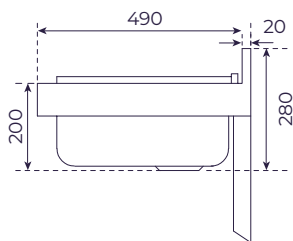

Features

- Grade 304 (18/10) stainless steel
- Durable and hygienic
- Pressed bowl
- Stainless steel hinged bucket grid
- Stainless steel wall mounting galvanised brackets

Product Code	Dimensions (L x W)	Depth (mm)
SDRIP-STD (KDSG)	530 x 490	200

Specifications

Kwikot SDRIP-STD (KDSG) Drip Sink, manufactured in grade 304 (18/10) stainless steel, size 530 x 490 x 200mm deep, complete with stainless steel hinged bucket grid with 100mm integral splashback to back. Unit fitted with 40 x 40mm square stainless steel wall brackets and provision for 90mm waste outlet. (90mm basket strainer waste fitting included). Unit to be fitted 600mm from finished floor level.

Pictures may vary from the actual product. Specifications may differ and will be subject to actual product (E and OE).

Hospital equipment

Drip Sinks



Dimensions

Plan view

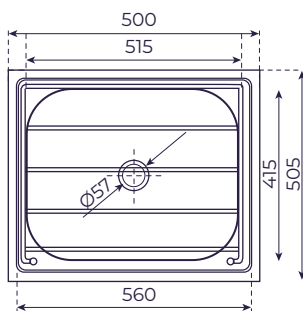

End view

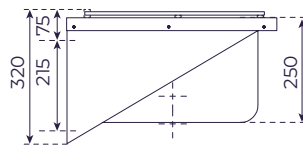

Features

- Grade 304 (18/10) stainless steel
- Durable and hygienic
- Pressed bowl
- Stainless steel hinged bucket grid
- Stainless steel wall mounting brackets

Product Code	Dimensions (L x W)	Depth (mm)
SDRIP-PRESSED	600 x 500	250

Specifications

Kwikot SDRIP-PRESSED Drip Sink manufactured from grade 304 (18/10) stainless steel, size 600 x 500 x 250mm deep pressed bowl with hinged bucket grid and provision for Ø40mm waste outlet fitted with stainless steel brackets to be bolted to the wall.

Hospital equipment

Surgeon Scrub-up Units

Features

- Grade 304 (18/10) stainless steel
1,2mm gauge
- Sound deadened with galvanised
backing sheet
- Durable and hygienic
- Deep hospital bead to prevent
spilling
- Floor mounted

SSCF



Dimensions

Plan view

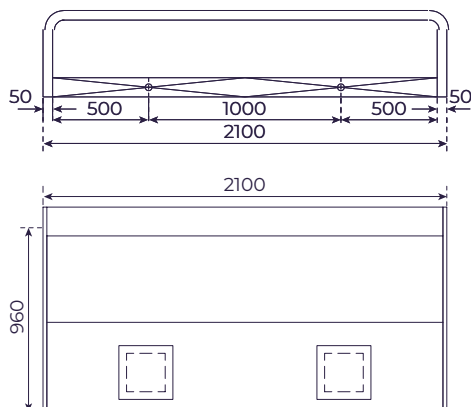

End view

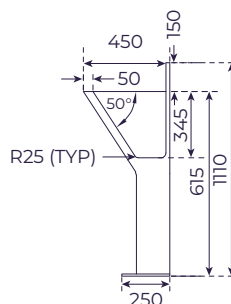

Specifications

Kwikot model SSCF Floor Mounted Surgeon's Scrub-up Unit, manufactured from 1,6mm thick grade 304 (18/10) stainless steel with 150mm high integral splashback to back, radiused internal corners with provision for 40mm round outlet/s. The front and sides of the unit to be of double walled construction with inner walls sprayed with bitumastic sound deadening with removable inspection panel/s opposite each panel on the face.

Product Code	Dimensions (L x W)	Number of Outlets
SSCF-1200	1200 x 450	1
SSCF-1500	1200 x 450	1
SSCF-1800	1200 x 450	2
SSCF-2100	1200 x 450	2

* Custom sizes available on request

Pictures may vary from the actual product. Specifications may differ and will be subject to actual product (E and OE).

Hospital equipment

Surgeon Scrub-up Units

Features

- Grade 304 (18/10) stainless steel 1,2mm gauge
- Sound deadened with galvanised backing sheet
- Durable and hygienic
- Deep hospital bead to prevent spilling
- Wall mounted

SSCW



Dimensions

Plan view

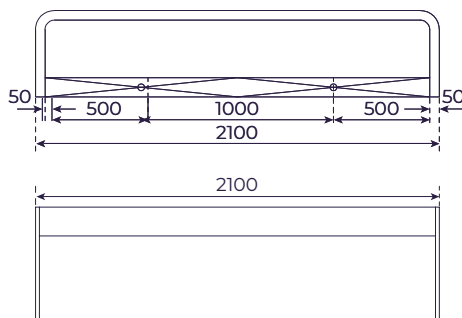

Side view

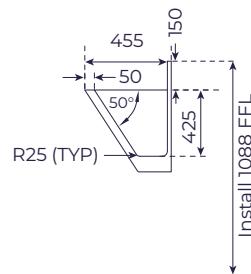

Specifications

Kwikot model SSCW Wall Mounted Surgeon's Scrub-up Unit, manufactured from 1,6mm thick grade 304 (18/10) stainless steel with 150mm high integral splashback to back, radiused internal corners with provision for 40mm round outlet/s. The front and sides of the unit to be of double walled construction with inner walls sprayed with bitumastic sound deadening complete with removable galvanized fixing plate for fixing to the wall.

Product Code	Dimensions (L x W)	Number of Outlets
SSCW-1200	1200 x 455	1
SSCW-1500	1500 x 455	1
SSCW-1800	1800 x 455	2
SSCW-2100	2100 x 455	2

* Custom sizes available on request

Pictures may vary from the actual product. Specifications may differ and will be subject to actual product (E and OE).

Hospital equipment

Mini Surgeon Scrub-up Unit

Features

- Grade 304 (18/10) stainless steel
- Durable and hygienic
- Wall mounted supplied with galvanized fixing plate.



SSCW-MIN

Dimensions

Plan view

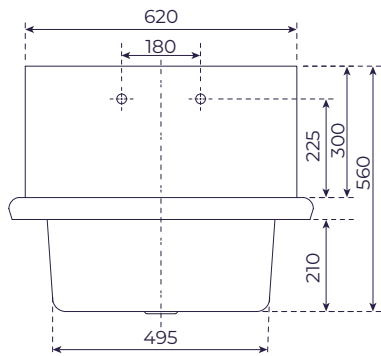

End view

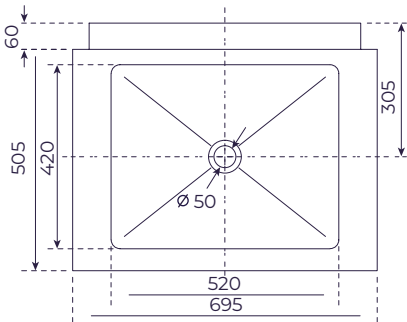

Product Code	Dimensions (L x W)	Depth (mm)
SSCW-MIN	695 x 550	260

Specifications

Kwikot Model SSCW-MIN Wall Mounted Mini Surgeon Scrub-up Unit 695 x 550x 260mm deep, manufactured from 1,2mm thick grade 304 (18/10) stainless steel with 305mm high integral splashback to back, radiused internal corners with provision for 40mm round outlet and two 22mm tap holes.

Pictures may vary from the actual product. Specifications may differ and will be subject to actual product (E and OE).

Hospital equipment

Plaster of Paris Preparation Sink

Features

- Grade 304 (18/10) stainless steel
- Durable and hygienic
- Plaster bowl with removable strainer and lid
- Hospital bead to prevent spillage
- Rinse bowl discharging into plaster bowl



POPGL

Dimensions

Plan view

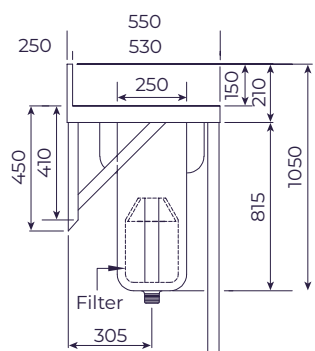

End view

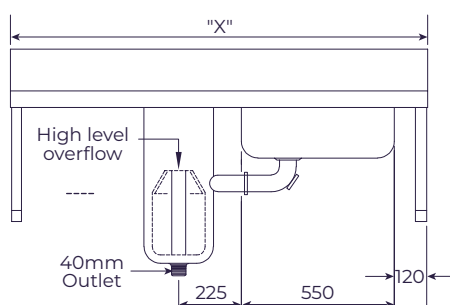

Product Code	Sink Dimensions (L x W mm)	Prep Bowl Depth (mm)	Cylinder Depth (mm)
SPOP-1320	1320 x 550	230	625
SPOP-1500	1500 x 550	230	625
SPOP-1500	1850x 550	230	625
SPOP-2100	2100 x 550	230	625
SPOP-2100	2400 x 550	230	625

Specifications

Kwikot Model POPGL Plaster of Paris Preparation Sink, manufactured in 1,2mm thick grade 304 (18/10) stainless steel with a 150mm high integral splashback to the rear. Size (Please Specify). The unit fitted with a preparation bowl measuring 550 x 375 x 230mm deep with a waste outlet discharging into cylinder measuring 250mm round and 625 mm deep. Waste cylinder fitted with stainless steel lid and removable strainer with provision for 40mm Ø round waste outlet. The underside of the draining board fitted with mild steel galvanized backing sheet and supporting frame. Unit to be fitted with 40 x 40mm square stainless steel gallows brackets and 40mm square stainless steel front legs with adjustable foot pieces OR for 41mm Ø round legs with adjustable foot pieces.

Pictures may vary from the actual product. Specifications may differ and will be subject to actual product (E and OE).

Hospital equipment

Baby Baths

Features

- Grade 304 (18/10) stainless steel
- Durable and hygienic
- Semi-circular bowl
- Recessed drainer to help avoid water spillage



BBGL



BBDI

BBGB/BBL

Dimensions

Plan view

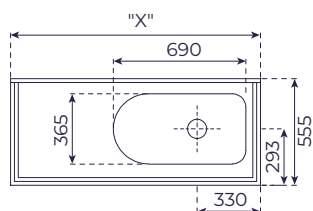

End view

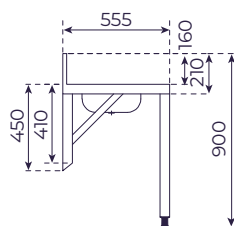

Product Code	Dimensions (mm) (L x H)	Fixing Method
BBGB	1500 x 555	Stainless steel gallows brackets and front legs
BBL	1500 x 555	Stainless steel legs

BBDI

Plan view

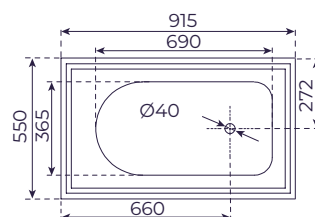

End view

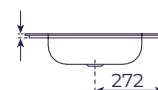

Product Code	Dimensions (mm) (L x H)	Bowl Depth (mm)
BBDI	915 x 550	165

Specifications

Kwikot BBGB/BBL (please specify) Baby Bath manufactured in 1,2mm thick grade 304(18/10) stainless steel, length 1500mm or 1320mm long (please specify) x 555mm wide, with a 150mm integral splashback. The unit shall be fitted with a semi-circular bowl measuring 690 x 355 x 165mm deep with provision for 40mm Ø round waste outlet the underside of the drainer shall have a vermin proof bitumastic sound deadening supported with a galvanized backing sheet. Unit mounted on to 40mm Ø round stainless steel legs with adjustable foot pieces

(Model BBL) or 40 x 40mm stainless steel gallows brackets with 41mm Ø round stainless steel front legs with adjustable foot pieces for fixing to wall and floor (Model BBGB) (please specify)

Kwikot BBDI Inset Baby Bath manufactured in 1,2mm thick grade 304(18/10) stainless steel, size 915 x 550mm deep. The unit shall be fitted with a semi-circular bowl measuring 690 x 365 x 165mm deep with provision for 40mm Ø round waste outlet. Cut out size 875 x 515mm.

Pictures may vary from the actual product. Specifications may differ and will be subject to actual product (E and OE).

Mortuary equipment

Post Mortem Tables

Features

- Grade 304 (18/10) stainless steel 1,2mm gauge
- Durable and hygienic
- Recessed slab with 25mm deep ledge
- Sound deadened with galvanised backing sheet



KMT

KMTS

KMT

Dimensions

Plan view

End view

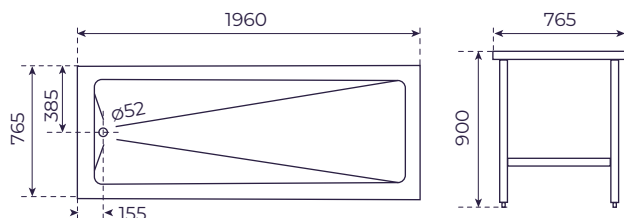

KMT

Height (mm)	900
Width (mm)	765
Length (mm)	1980

KMTS

Plan view

End view

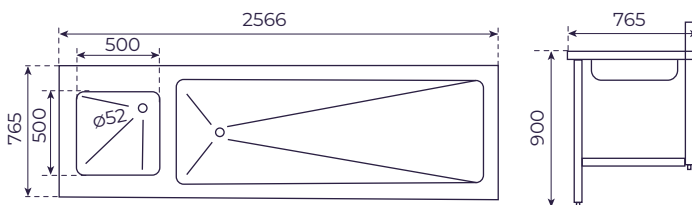

KMTS

Height (mm)	900
Width (mm)	765
Depth (mm)	2566

Specifications

Kwikot Model KMT Post Mortem Table is manufactured from grade 304 (18/10) stainless steel. Slab constructed with provision for 40mm round waste outlet and 25mm deep recess around edges, fully sound deadened galvanised backing sheet and frame. Fitted on to four 41 mm round stainless steel legs and cross braces, each leg fitted with adjustable foot piece.

Kwikot Model KMTS Post Mortem Table is manufactured from grade 304 (18/10) stainless steel. Rinse Bowl 500 x 500 x 230mm deep and provision for 40mm round waste outlet. Slab constructed with 40mm round waste outlet and 25mm deep recess around edges, fully sound deadened galvanised backing sheet and frame. Fitted on to six 41mm round stainless steel legs and cross braces, each leg fitted with adjustable foot piece.

Pictures may vary from the actual product. Specifications may differ and will be subject to actual product (E and OE).

Hospital Shelving

Supplied and installed by Kwikot



Hospital equipment

Shelving



Solid



Perforated

Z-SERIES

Dimensions

Standard Sizes - Wall Bands

Product Code	Length (mm)	Slotted
SSWBSZ-1000	1000	Single
SSWBSZ-1800	1800	Single
SSWBDZ-1000	1000	Double
SSWBDZ-1800	1800	Double

Standard Sizes - Z-Series Shelving

Product Code	Dimensions (L x W mm)	Finish
SSZSS-900-300	900 x 300	Solid
SSZSS-900-400	900 x 400	Solid
SSZSS-1200-300	1200 x 300	Solid
SSZSS-1200-400	1200 x 400	Solid
SSZPS-900-300	900 x 300	Perforated
SSZPS-900-400	900 x 400	Perforated
SSZPS-1200-300	1200 x 300	Perforated
SSZPS-1200-400	1200 x 400	Perforated

Features

- Grade 304 (18/10) stainless steel
- Durable and Hygienic
- Easy to assemble, expand and adjust
- Solid/perforated finish

Specifications

Kwikot Z-Series Adjustable Shelving, size (please specify), manufactured from 1,2mm thick grade 304 (18/10) stainless steel. One piece solid or perforated (please specify) shelf with integrated brackets and a 25mm apron to front and sides, with 30mm turn up at back and safety edge on corners. An additional offer is the compatible Kwikot Z-Series 1000mm/1500mm/1800mm sizes (please specify) long single/double (please specify) slotted Wall Bands manufactured from 1,2mm thick grade 304, (18/10) stainless steel. (Custom sizes of shelves and wall bands are also available on request).

Hospital equipment

Fast Rack Modular Shelving - Solid or Louvered Shelves

Features

- Grade 304 (18/10) Stainless Steel.
- Durable and hygienic.
- Easy to assemble, expand and adjust

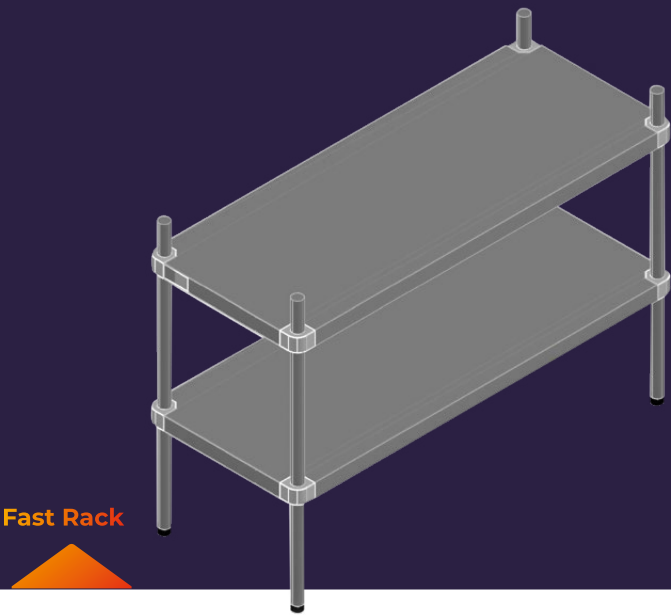

Dimensions

Product Code	Length x width	Finish
SSMSS-900-400	900 x 400mm	Solid
SSMSS-1200-400	1200 x 400mm	Solid
SSMPS-900-400	900 x 400mm	Louvered
SSMPS-1200-400	1200 x 400mm	Louvered

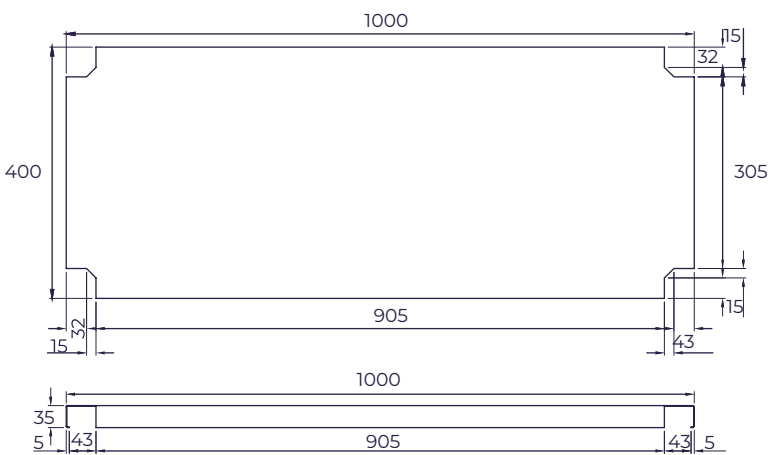

Features

Specifications

Specification for Fast Rack Modular Shelving (Solid or Louvered Shelves)

Kwikot Fast rack Modular Shelving Solid or Perforated Shelves (please specify), size (please specify), manufactured from 1,2mm thick grade 304, (18/10) stainless steel with die cast aluminum corner brackets for fixing to 25mm diameter, vertical posts.

Vertical posts manufactured from 1,2mm thick 25mm diameter stainless steel and fitted with end caps at one end and adjustable foot pieces and full set of 4 posts.

(Custom sizes of Shelves and Posts are also available on request).

Pictures may vary from the actual product. Specifications may differ and will be subject to actual product (E and OE).



Hospital equipment

Kwikboil Instant Boiling Water Dispensers - Boiling Water On Tap, 24/7



Kwikboil 2.5 / 5 / 7.5 / 10 / 15
White Epoxy or Stainless Steel

Dimensions

Front view

Side view

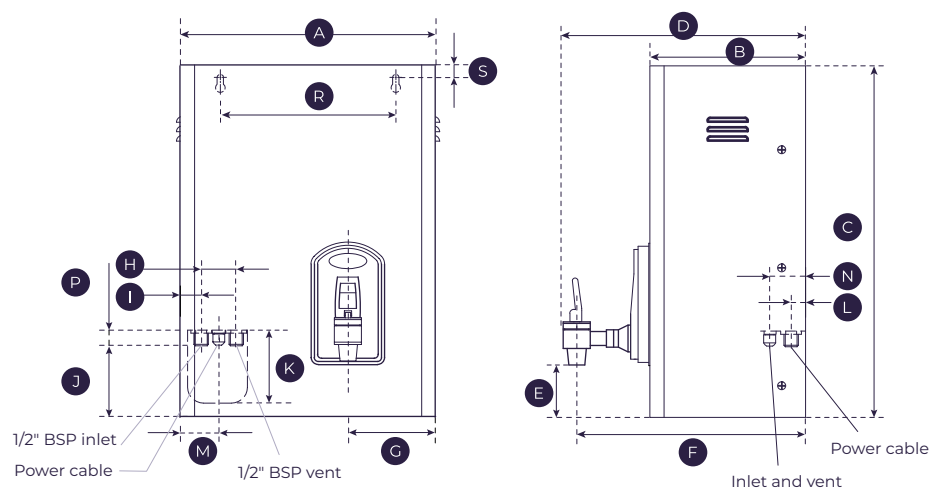

Features

- Stainless steel or white epoxy outer casing
- On tap boiling water
- Wall mounted
- Fully automatic
- Advanced electronic controls
- Safe, hygienic and energy efficient
- Steam free and convenient
- Diagnostic PC board for fault finding

Size	A	B	C	D	E	F	G	H	I	J	K	L	M	N	P	R	S	T
Kwikboil 2,5 L	275	165	365	263	82	243	110	44	28	90	93	18	49	45	20	220	16	N/A
Kwikboil 5L	320	195	448	293	82	273	110	44	28	90	93	18	49	45	20	220	16	N/A
Kwikboil 7,5 L	320	195	448	293	82	273	110	44	28	90	93	18	49	45	20	220	16	N/A
Kwikboil 10 L	348	225	460	323	82	303	137	44	28	90	93	18	49	45	20	220	16	N/A
Kwikboil 15 L	370	230	513	328	82	306	140	44	28	90	93	18	49	45	20	220	16	N/A

NB. Operates at 230 Volts AC, 50 Hz single phase electricity. Flexible 1,5m electrical cord with a 3 pin plug fitted to all units.

Pictures may vary from the actual product. Specifications may differ and will be subject to actual product (E and OE).

Hospital equipment

Kwikboil Instant Boiling Water Dispensers - Boiling Water On Tap, 24/7



Kwikboil 25
White Epoxy or Stainless Steel

Dimensions

Front view

Side view

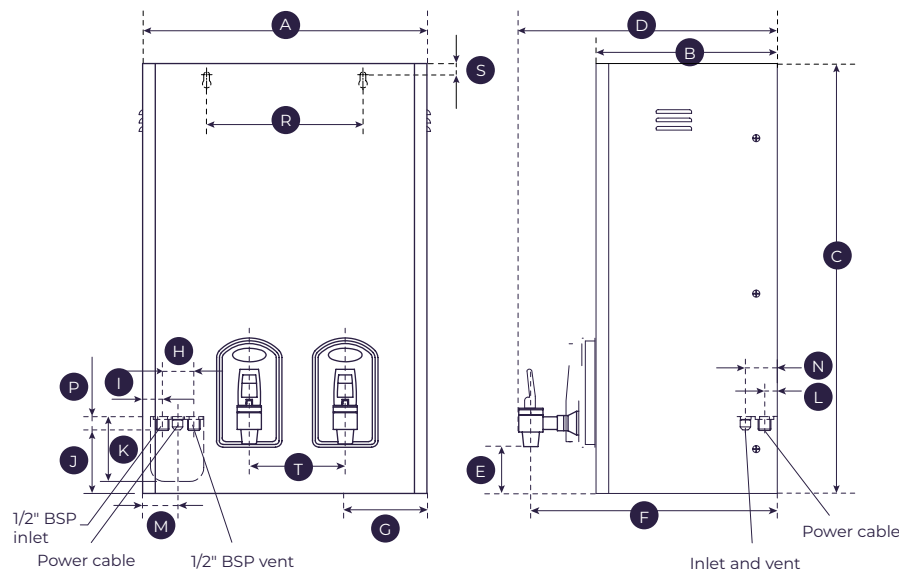

Product accessories



KB-SSTRAY
Stainless Steel Drip Tray

Specifications

Outer Dimensions (mm)	335 x 255
Inner Dimensions (mm)	300 x 235
Depth (mm)	50

Size	A	B	C	D	E	F	G	H	I	J	K	L	M	N	P	R	S	T
Kwikboil 2,5 L	400	255	613	353	82	333	115	44	28	90	93	18	49	45	20	220	16	135

Specifications

Kwikot KwikBoil Instant Boiling Water available in a white Epoxy finish or Stainless steel. Fitted with an Incalloy hard water heating element, with safety cut out. The inner tank (boiling water chamber) is manufactured from copper and the unit has a self diagnostic PC board with easy fault finding indicative LED lights. The unit operates at 230 volts AC, 50Hz, single phase electricity, operates under 15 amps and is fitted with a 1,5m electrical cord with a 3 pin plug fitted onto it. Ideal for coffee and tea but also not limited to sterilization of baby bottles etc.

Kwikboil units are available in the following capacities: 2,5L; 5L; 7,5L; 10L; 15L and 25L.

Pictures may vary from the actual product. Specifications may differ and will be subject to actual product (E and OE).

Register Your Kwikot Product Today!

Why Register?

Ensure peace of mind by registering your Kwikot product and enjoy these exclusive benefits:

- **Full Warranty Activation** – Get complete coverage for your product.
- **Stay Informed** – Receive important safety and product updates.
- **Proof of Ownership** – Simplify future service or support requests.

Who Can Register?

- Homeowners who have purchased and installed a Kwikot product.
- Licensed plumbers or installers registering on behalf of clients.

What You'll Need to Register:

- Installation date.
- Product serial number. (found on your water heater)
- Proof of purchase or installation. (optional upload)
- Contact details. (name, email, phone number)

To Validate the Warranty

(Please Register Online)

Kwikot has taken a significant step towards enhancing their customer service by introducing new Water Care product registrations. Through this new process, customers and installers can register their water heaters and water care products by scanning the product registration QR code (which can be found on the water heater) via a smart phone or manually entering the information on **www.kwikot.com**

This registration process enables service agents to access product information promptly, allowing for more efficient handling of warranty claims and a convenient experience for customers. This initiative reflects our unwavering commitment to delivering exceptional service to our valued customers.

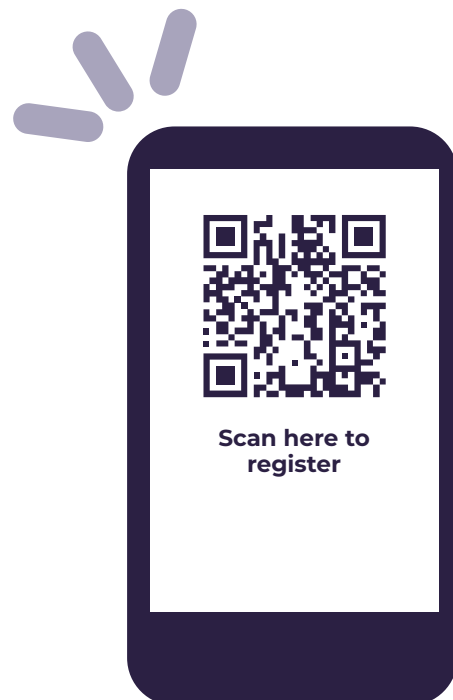





KWIKOT

powered by **Haier**

Need Assistance?

Sales and Payment Queries:
za_salesorders@kwikot.com | **011 897 4600**

Admin, Marketing and Product Queries:
kwikot.marketinginfo@kwikot.com

Technical Queries:
technical.info@kwikot.com

Gauteng
3 Aberdeen Road
Industrial Sites
Benoni

KwaZulu-Natal
814 Peter Close
Springfield Park
Durban

Western Cape
15 Purdey Road
Sheffield Business Park
Phillippi, Cape Town

Eastern Cape
39-41 Leadwood
Crescent
Fairview
Port Elizabeth