

# RCT T-1000LFP MEGAPOWER LiFePo TROLLEY

- Pure Sinewave for Sensitive Electronics & Motorised Loads
- Microprocessor Control Optimizes Reliability
- Input Power Factor Correction
- Output Power Factor 1.0
- Display Allows Easy Monitoring & Access of UPS Status
- Built-in MPPT solar charger
- 2 x USB 5 V DC output and 2 x 12 V DC output
- Battery cut off switch for safety
- Lithium Battery - 3 years (Pre-installed batteries)

## INVERTER BATTERY

<b>12 V</b> Battery Voltage	<b>100 AH / 12 V</b> In-built Battery Specification	<b>1200Wh</b> LiFePo Battery Capacity
--------------------------------	--	--

INVERTER

**RATED POWER:**  
1000 W

**OUTPUT VOLTAGE:**  
220 VAC

**OUTPUT FREQUENCY:**  
50 / 60 Hz

**OUTPUT WAVEFORM:**  
Pure Sine Wave



**CHARGE BY A MAINS SUPPLY**

**RATED VOLTAGE:** 220 VAC | **CHARGE CURRENT:** 15 A (Max.)

**SOLAR INPUT**

**MAXIMUM PHOTOVOLTAIC VOLTAGE (VDC):**  $\leq 25$  V

**CHARGE VOLTAGE (VDC):** 10 V - 25 V

**RATED CHARGE CURRENT (A):** 30 A

**MAXIMUM POWER (Wp):** 360 Wp

**VOLTAGE OVERCHARGE PROTECTION (VDC):** 14.2 V

**VOLTAGE OVERCHARGE RECOVERY (VDC):** 14.0 V

**VOLTAGE OF FLOATING CHARGE (VDC):** 13.7 V

**OUTPUT**

**AC OUTPUT:**

2 x SA 3 Pin Socket - 230 V 50 Hz, 1000 VA / 1000 W Max. (Combined)

**USB OUTPUT:**

2 x USB Type A Port - 5 VDC 2 A Max.

**DC OUTPUT:**

2 x 12 V DC Port 2 A Max.

**BATTERY TYPE:**

1 x 12V DC 100Ah Lithium Iron Phosphate Battery

### PRODUCT INFORMATION

- |                      |                      |
|----------------------|----------------------|
| 1. AC Output         | 8. LCD Display       |
| 2. Smart Cooling Fan | 9. Function Buttons  |
| 3. AC Input          | 10. On / Off Buttons |
| 4. Solar PV Input    | 11. 5VDC Output      |
| 5. Battery Extension | 12. 12VDC Output     |
| 6. Battery Switch    | 13. DC Output Switch |
| 7. Led Indicator     |                      |

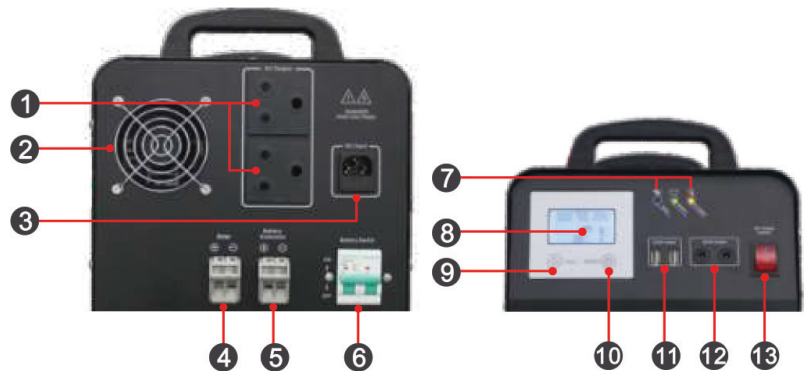

### RUNTIME BASED ON 1X 12V DC 100Ah BATTERY

MOBILE PHONE 5W + LED LAMP 2 X 5W + WI-FI ROUTER 30W + LAPTOP 55W = 100W 6 HOURS ESTIMATE RUNTIME

MOBILE PHONE 5W + LED LAMP 2 X 5W + WI-FI ROUTER 30W + TABLET 20W + LAPTOP 55W + LED MONITOR 30W = 150W 4 HOURS ESTIMATE RUNTIME

MOBILE PHONE 5W + LED LAMP 2 X 5W + WI-FI ROUTER 30W + LAPTOP 55W + LED TV 100W = 200W 3 HOURS ESTIMATE RUNTIME

MOBILE PHONE 2 X 5W + LED LAMP 2 X 5W + WI-FI ROUTER 30W + TABLET 20W + SATELLITE 30W + LED TV 50W - 150W + DESKTOP 50W - 150W = 400W 1.5 HOURS ESTIMATE RUNTIME

**\*Warranty Electronics - 1 year; Lithium Battery - 3 years. Battery Recharge time - plus minus 8 hours.**

Derate to 80% of capacity in frequency converter mode and to 80% when the output voltage is adjusted to 200 / 208 / VAC. Product specifications are subject to change without further notice.

**PRODUCT DIMENSIONS: 423 mm x 260 mm x 453 mm**

**RCT**

[WWW.RCTZONE.CO.ZA](http://WWW.RCTZONE.CO.ZA)